



Technical Specifications document

Last updated:
2 December 2010

Technical Specifications

2 December 2010



SOUND

Primary system

- 4 x RCF TT 22A 12" two way powered Loudspeakers c/w flying brackets
- 2 x RCF TTS 18 18" Powered Subwoofer
- 1 x PreSonus SL 24:4:2 24 Channel Digital Mixer w/ FX and EQ
- 1 x Shure DMK5257 beta 52 with 3 x SM 57, Case & clips
- 2 x Countryman Type 85 DI boxes
- 2 x Proco iFace Consumer to pro stereo interface
- 3 x SM 58, + stands
- 2 x Studio Projects C4ii small condenser mics (factory matched pair) + stands
- 1 x 30m 16/4 XLR snake

Additional equipment

- 2 x Bose 802 III Speakers
- 2 x Bose 502b subwoofers
- 1 x Bose PSC II system controller
- 2 x Mackie SRM350 active speakers
- 1 x Digam Powersoft Amplifier (4 x channels)
- 1 x 'Soundking' 300w Power Amplifier (2 x channels – note has jack inputs only)
- Allen & Heath 14:4:2 MixWizard sound desk
- 1 x ACL2 Pro Compressor/limiter/gate
- 1 x Firebox
- Sony CD player with auto pause function
- Numark MP3 CD player

Oceania Audio supplies all other equipment at a discount rate.
Should anything extra be required, Downstage will provide quotes.

Technical Specifications

2 December 2010



PROJECTION

- 2 x Mitsubishi XD600U 4500 lumen data projectors c/w hanging brackets
- 2 x 150" 4:3 format screens with both front and rear surfaces
- 2 x 7" Touchscreen LCD with VDA's
- Mac Pro Dual 2.8GHz Quad core CPU, 10GB RAM, 320GB Superdrive OS 10.6
- 20" LCD monitor
- 1 x Sony CX75 2500 lumen data projector c/w hanging cradle

COMMUNICATIONS

- 2 way hard wired comms with visual flash capacity for SM/Operator contact
- Uniden UHO38sx R.T's for SM/Tech/FOH contact

MASKING

Wool serge black drapes available to create black box effect in end stage configuration.

Technical Specifications

2 December 2010

STAGE & ENTRANCES

- Stage Right - 826 mm wide x 1910 mm high
- Up Stage Right - 1210 mm wide x 1640 mm high
- Up Stage Centre – 2430 mm wide x 1640 mm high
- Up Stage Left – 1710 mm wide x 5610 mm high
- Down Stage Left – 1220 mm wide x 1900 mm high (DSL entrance actual H is 2800, but is not marked as such because of proximity to stage edge)

Stage Floor Plan Detail

- Broken lines show edge of balcony – underside is 2800mm to auditorium floor.
- Balcony floor to auditorium floor is 3020mm

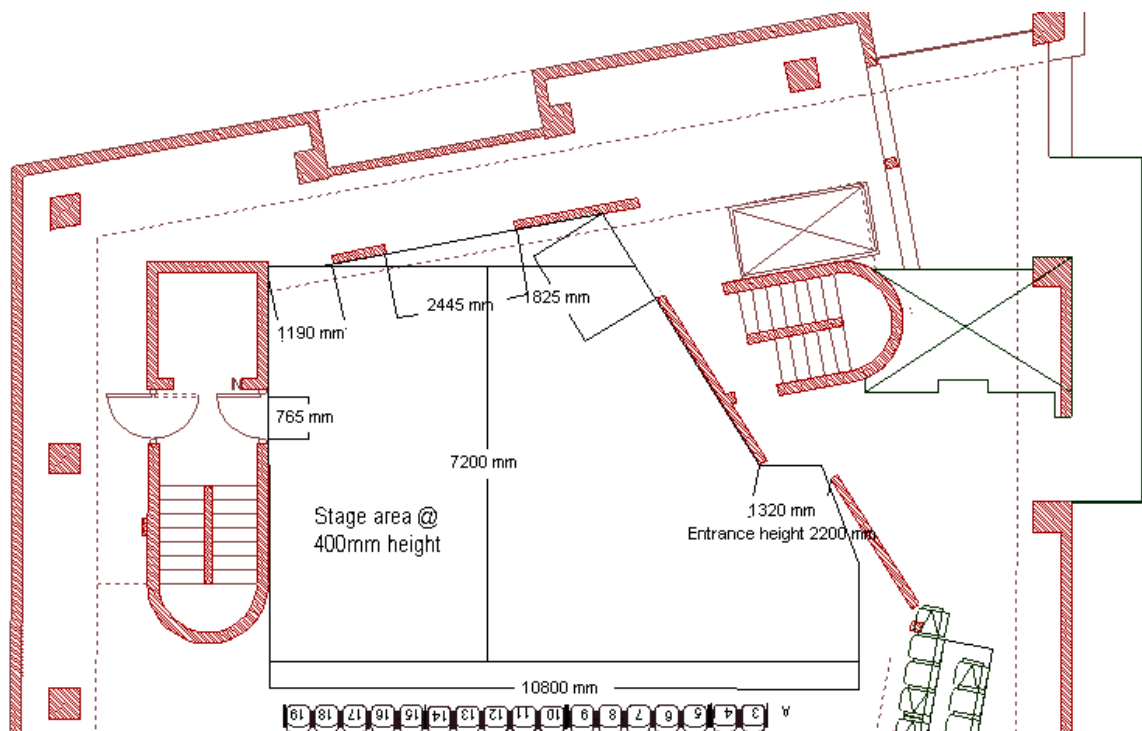

Treads provide access to the stage, and can be placed where needed.

Technical Specifications

2 December 2010



ACCESS & LOADING

Parking

Downstage's dockway is available for loading/unloading. It must be kept clear one hour prior to performance and during performance as it is used as an evacuation point on our emergency evacuation plan.

There is also a loading zone directly outside the main public entrance to the building.

The closest mobility parking space is in Blair Street.

There is no staff parking or casual parking available.

Dockway & Trap

The Dockway provides access directly to the auditorium via a trapdoor and a monorail hoist.

Dockway Trap – 2440 long x 1220 mm wide

Monorail Hoist (dockway to stage) max weight 500kg

Accessibility

We like to know that we are accessible to all of our patrons and to accommodate you the best we can, if you require any of these services please let our Box Office know when making your booking.

Lift Access	Downstage has lift access to two levels. Our lift is located to the right just as you enter the main doors.
Wheelchair	we have seating space available for patrons with wheelchairs. Please let our Box Office know if you have a wheelchair and carer or coming in a group.
Companion	we offer one complimentary ticket for patrons accompanying mobility impaired ticket holders
Bathroom	we have a wheelchair accessible bathroom
Hearing loop	Downstage is looped for the hearing impaired and we now provide the option of telemagnetic receivers to cater for digital hearing aids
Guide dog	visually impaired patrons with guide dogs are welcome at Downstage
Babes in Arms	for the comfort of other Patrons, we ask that parents with babes in arms sit near the lift foyer exit. If baby makes a disturbance, please exit the auditorium and return once the child is re-settled

Technical Specifications

2 December 2010



ADDITIONAL INFORMATION

Dressing Rooms

- 2 x secure medium sized rooms, can accommodate maximum of 5 people in each
- Larger dressing room space, can accommodate maximum of 4 people
- All spaces have wash basins with hot & cold running water
- Backstage bathroom:
 - Single shower
 - Single toilet
 - Disabled toilet & shower
 - 2 x basins with hot & cold running water

Laundry

- Front Loader washing machine
- Drier
- Iron & ironing board
- Clothes drying horse
- Tub with hot & cold running water

Greenroom

- Fully functional kitchen
- Dishwasher
- Fridge/freezer
- Insinkerator
- Rubbish & recycling removal
- Table, chairs, couches
- Telephone

Technical Specifications

2 December 2010



PRODUCTION CONTACT

Simon Rayner

Production & Facilities Manager

DDI: +64 04) 802 6397

Cell: +64 021 672 524

production_manager@downstage.co.nz

Marc Edwards

House Technician

DDI: +64 04) 802 6399

Cell: +64 021 566 021

technician@downstage.co.nz

Sonia Hardie

Associate Producer; Logistics & Touring

DDI: +64 04) 802 6399

Cell: +64 021 0228 6790

sonia@downstage.co.nz



Hannah Playhouse

12 Cambridge Terrace

PO Box 9441

Wellington 6141

Tel: +64 04) 801 6946

Fax: +64 04) 801 6948

www.downstage.co.nz